

This drawing is the sole property of Miether Bearing Products and contains confidential and proprietary information. It is being provided to you for your use and may not be disclosed to any third party or used for any other purpose without Miether's prior written consent. The [materials] must be returned to the Company upon its demand. Your acceptance of these materials constitutes your acceptance of the foregoing terms.

C-28016

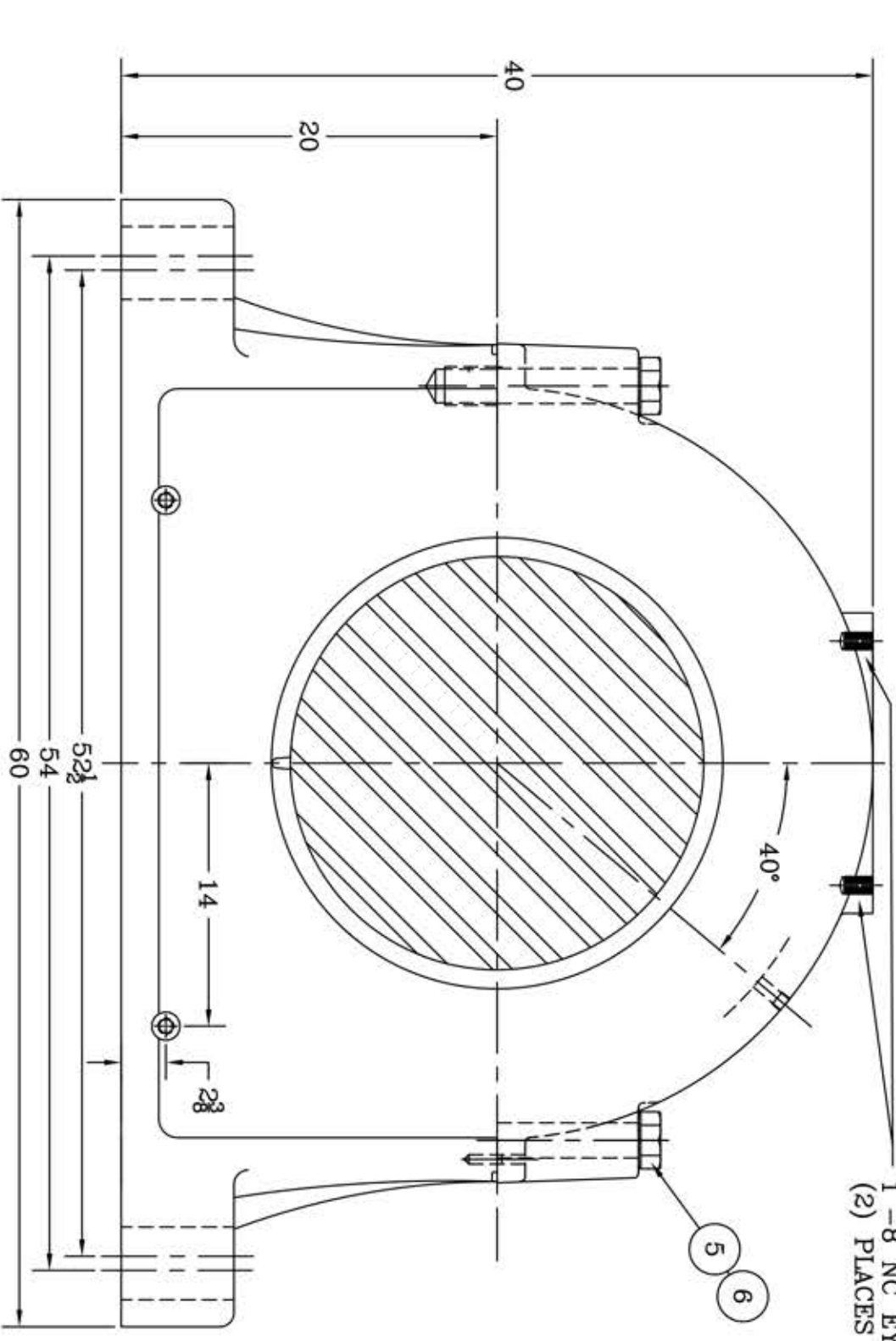

ITEM	DESCRIPTION	DETAIL	QTY.
1	HOUSING SDAF 30/600 K x 22	TBA	1
2	SPHERICAL ROLLER BRG.	230/600 K	1
3	STABILIZING RING SR-24967	A-24967	2
4	SEAL RING	TBA	2
5	HEX. HEAD CAP BOLT GR-5	1 1/2-5 NC x 11 LONG	6
6	LOCK WASHER	1 1/2 SPLIT MED.	6
7	PIPE PLUG	1 1/2-14 NPT	5
8	DOWEL PIN	1\"/>	
9	ADAPTER SNP 30/600 x 22	TBA	1

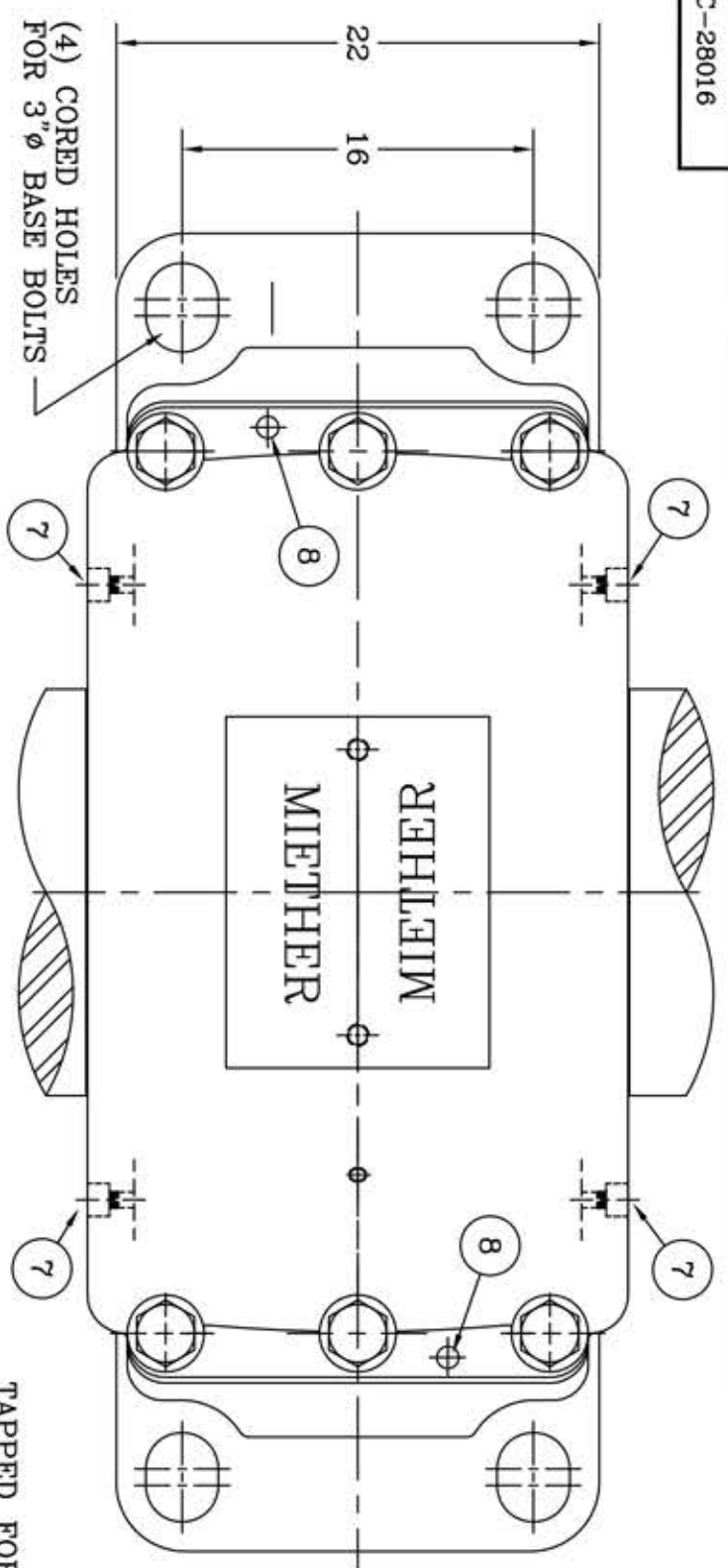
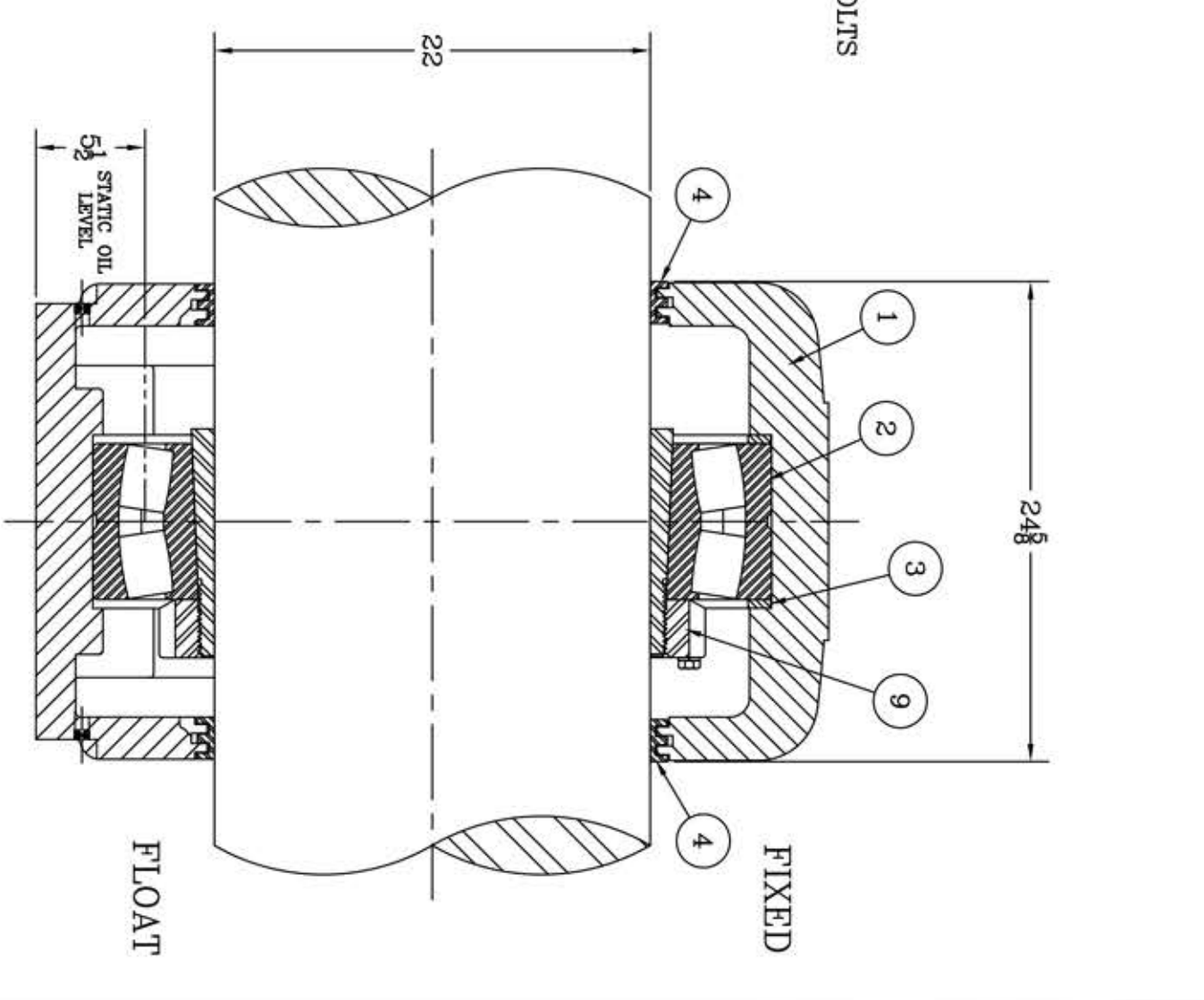

REVISIONS

S	DESCRIPTION	DATE
1	ASSEMBLY DRAWING	5-15-97

TOLERANCE: UNLESS OTHERWISE SPECIFIED

FRACTIONS $\pm 1/32$ " ANGLES $\pm 0^\circ 30'$

DECIMALS $\pm .005$ " WELD $\pm 1/16$ "

CASTING $\pm 1/16$ "

A.S.I. STANDARD FINISHES

SYMBOL	FINISH
∇	16
∇	32
∇	63
∇	125
∇	250
∇	500
∇	1000

AN ALCO INDUSTRIES COMPANY
BEARING PRODUCTS
ODESSA, TX. USA

SDAF 230/600 22-00
ASSEMBLY DRAWING

SCALE 1 = 6
DRAWN RWB
DATE 5-15-97
CHK:

ASSEMBLY NO.
DRAWING NO. C-28016